

# PRODUCT INFORMATION PACKET

Model No: 145TTDR6029  
Catalog No: U760  
2,1800,DP,145T,3/60/230/460  
Open Drip Proof (ODP)



Regal and Marathon are trademarks of Regal Beloit Corporation or one of its affiliated companies.  
©2018 Regal Beloit Corporation, All Rights Reserved. MC017097E





**Nameplate Specifications**

Output HP	2 Hp	Output KW	1.5 kW
Frequency	60 Hz	Voltage	230/460 V
Current	5.8/2.9 A	Speed	1745 rpm
Service Factor	1.15	Phase	3
Efficiency	86.5 %	Duty	Continuous
Insulation Class	F	Design Code	B
KVA Code	L	Frame	145T
Enclosure	Drip Proof	Overload Protector	No
Ambient Temperature	40 °C	Drive End Bearing Size	6205
Opp Drive End Bearing Size	6203	UL	Recognized
CSA	Y	CE	Y
IP Code	22		

**Technical Specifications**

Electrical Type	Squirrel Cage Inverter Rated	Starting Method	Line Or Inverter
Poles	4	Rotation	Reversible
Mounting	Rigid base	Motor Orientation	Horizontal
Drive End Bearing	Ball	Opp Drive End Bearing	Ball
Frame Material	Rolled Steel	Shaft Type	T
Overall Length	13.62 in	Frame Length	8.50 in
Shaft Diameter	0.875 in	Shaft Extension	2.37 in
Assembly/Box Mounting	F1 Only		
Outline Drawing	034908-850	Connection Diagram	005010-20ME

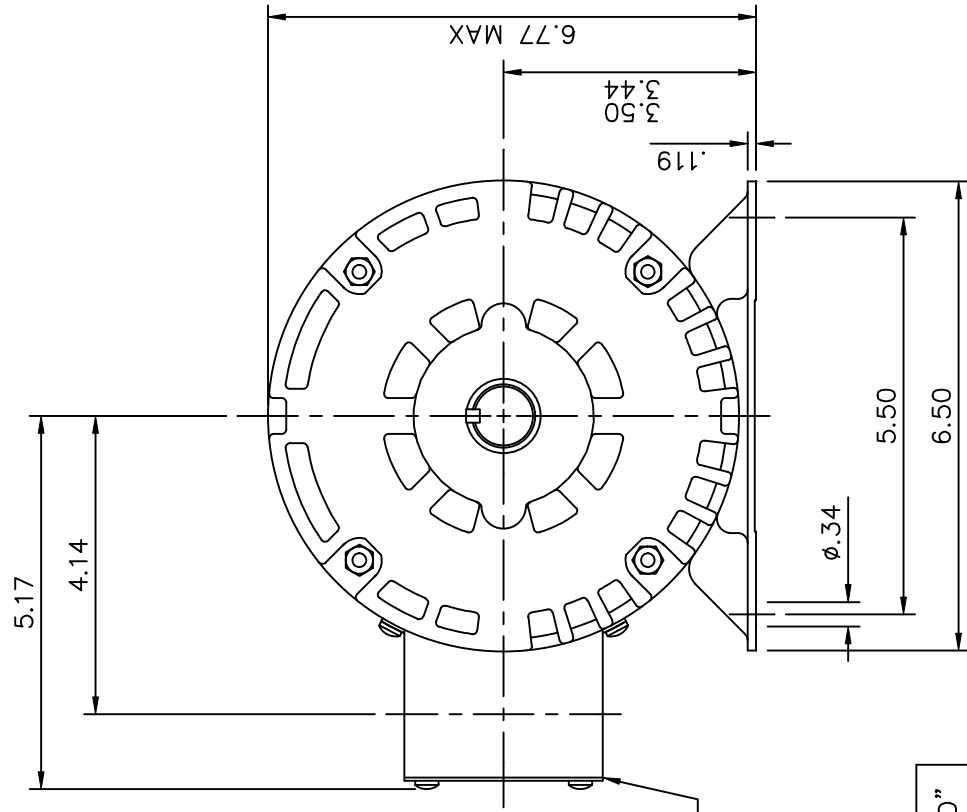

.19 SQ X 1.38 KEY

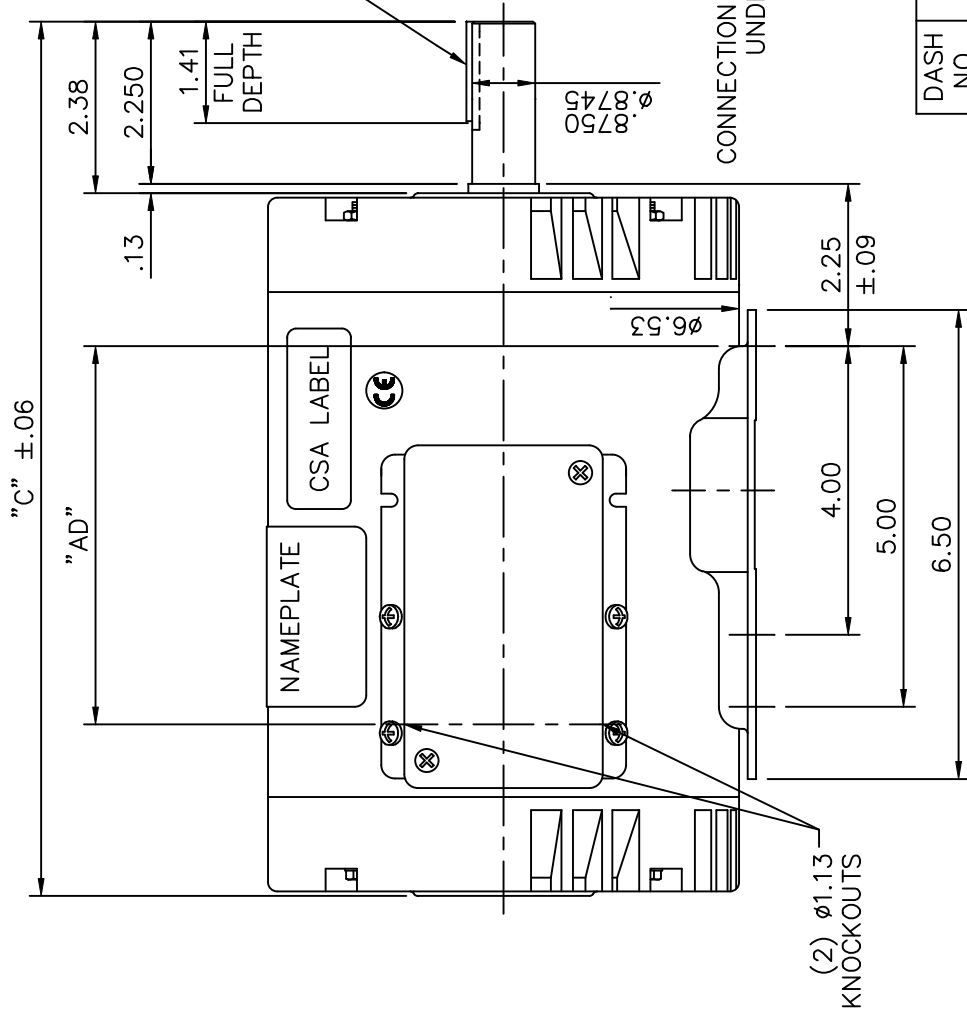

DASH NO.	"C"	"AD"
650	11.62	4.75
700	12.12	5.25
750	12.62	5.75
800	13.12	6.25
850	13.62	6.75

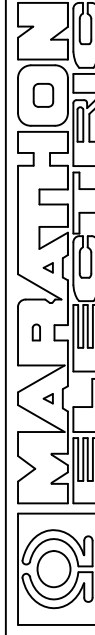

TITLE OUTLINE - 143T/145T FRAME  
DRIP PROOF - RIGID

DRAWN	RDW 12/13/01
CHK	
APPD	KMM 12/13/01
SCALE	3=8
REF	121003
FMF	
PREV	

TOLERANCES UNLESS SPECIFIED	
DEC.	INCHES
.X	±.1
.XX	±.03
.XXX	±.005
.XXXX	±.0005
ANG	±1/2°

NO.	01	ADDED CE LABEL	ARV 8/8/05	BY & DATE	CHK	ANG	±1/2°	FINISH		
THIS DRAWING IN DESIGN AND DETAIL IS OUR PROPERTY AND MUST NOT BE USED EXCEPT IN CONNECTION WITH OUR WORK ALL RIGHTS OF DESIGN AND INVENTION ARE RESERVED THIS IS AN ELECTRONICALLY GENERATED DOCUMENT - DO NOT SCALE THIS PRINT										
REVISION					RFP	12/13/01	CAD FILE	034908	SIZE	A
DRAWING NO. 034908										
REV. 01										

VIEW FROM OUTSIDE OF MOTOR AT SWITCH END.

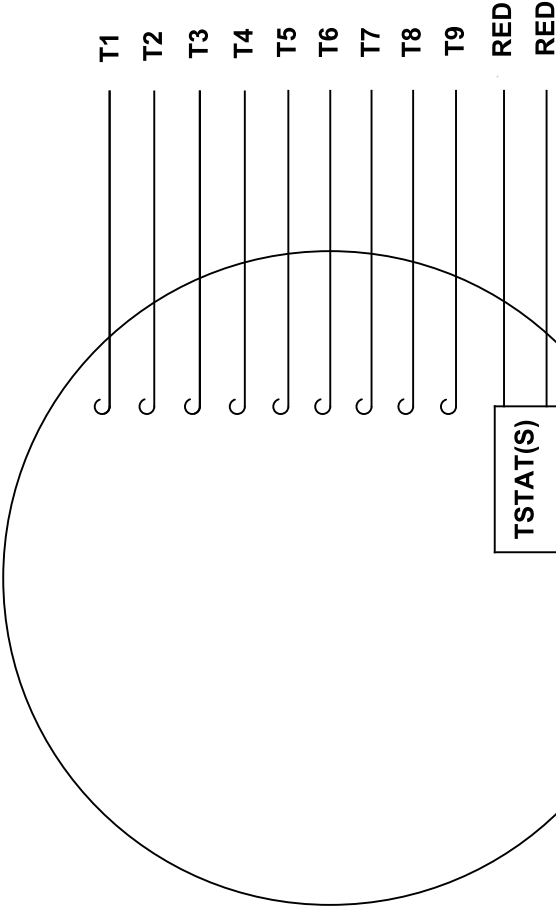

LINE LEADS

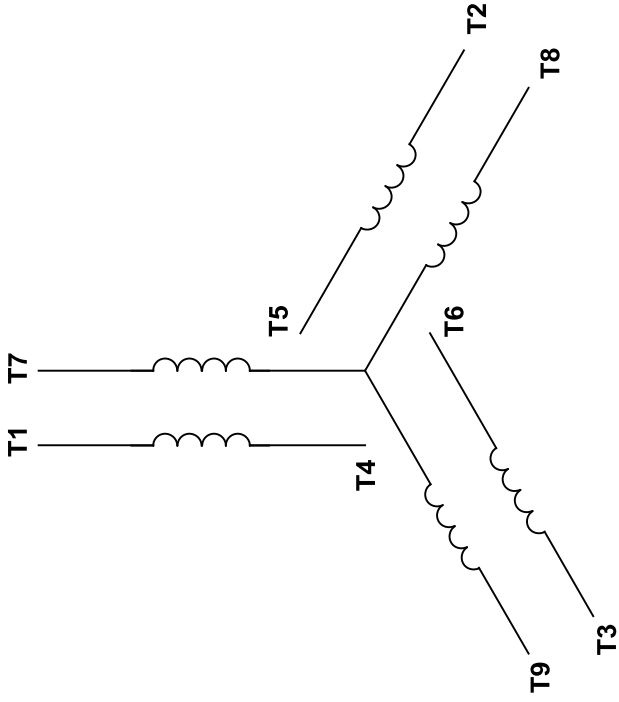

VOLTAGE	L1	L2	L3	JOIN & INSULATE
HIGH	T1	T2	T3	(T4, T7) (T5, T8) (T6, T9)
LOW	T1, T7	T2, T8	T3, T9	T4, T5, T6

RBC PROPRIETARY AND CONFIDENTIAL INFORMATION  
 This document is the property of REGAL BELOIT CORPORATION ("RBC") including its subsidiaries and divisions and contains proprietary information of RBC. This document is loaned on the express condition that neither it nor the information contained therein shall be disclosed to others without the express written consent of RBC, and that the information shall be used by the recipient only as approved expressly by RBC. This document shall be returned to RBC upon its request. This document may be subject to certain restrictions under U.S. export control laws and regulations.

TOLERANCES UNLESS SPECIFIED		DRAWN RDW 04/13/04	
DEC	INCHES	CHK	
.X	±.1	APPR	
.XX	±.01	SCALE	1:1
.XXX	±.005	REF	
.XXXX	±.0005	FMF	129027
CHK	ANG ±1/2°	PAGE	OF
BY & DATE	REV	SIZE	DRAWING NO
VJB 02/08/11		A	005010-20ME
REVISION	THIRD ANGLE PROJECTION	REV --	
REDRAWN IN SOLIDWORKS			
NETWORK FILE NAME	00501020ME		

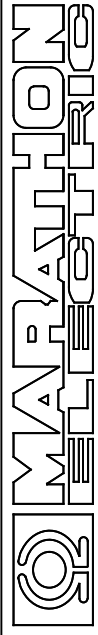

TITLE EXTERNAL WIRING DIAGRAM  
 3 PHASE

MAT'L DECAL - 004014 (TSTAT) - 080582

FINISH

PREV

CERTIFICATION DATA SHEET

Model#: 145TTDR6029 AA  
 CONN. DIAGRAM: 005010-20MIE  
 OUTLINE: 034908-850

WINDING#: T634340 DR 3  
 ASSEMBLY: F1 ONLY

TYPICAL MOTOR PERFORMANCE DATA

HP	2&1/2	KW	1.49&1.12	SYNC. RPM	1800	F.L. RPM	1745&1440	FRAME	145T	ENCLOSURE	DP	KVA CODE	L	DESIGN	B				
PH	3	HZ	60/50	VOLTS	230/460/190/380	FL AMPS	5.82/9&6/3	START TYPE	LINE OR INVERTER	DUTY	CONTINUOUS	INSL	F4	S.F	1.15/1.15	AMB°C	40	ELEVATION	3300
FULL LOAD EFF:	86.5&86.5	3/4 LOAD EFF:	85.6	1/2 LOAD EFF:	83.4	GTD. EFF		ELEC. TYPE		NO LOAD AMPS									
FULL LOAD PF:	75.6&68	3/4 LOAD PF:	64	1/2 LOAD PF:	51.9				0	SQ CAGE INV/RATED									3.4 / 1.7
F.L. TORQUE	6 LB-FT	LOCKED ROTOR AMPS	53.2 / 26.6	L.R. TORQUE	25.3 LB-FT 422	B.D. TORQUE	28.8 LB-FT 480	F.L. RISE°C											0
SOUND PRESSURE @ 3 FT.	0 dBA	SOUND POWER	10 dBA	ROTOR WK*2	0.162 LB-FT*2	MAX. WK*2	0.2 LB-FT*2	SAFE STALL TIME	10 SEC.	STARTS / HOUR	0	APPROX. MOTOR WGT	0 LBS.						

\*\*\* SUPPLEMENTAL INFORMATION \*\*\*

DE BRACKET TYPE	STANDARD	ODE BRACKET TYPE	STANDARD	MOUNT TYPE	RIGID	ORIENTATION	HORIZONTAL	SEVERE DUTY	FALSE	HAZARDOUS LOCATION	NONE	DRIP COVER	FALSE	SCREENS	NONE	PAINT	GREEN (ENAMEL)
BEARINGS DE	BALL 6205	OPE	BALL 6203	GREASE	POLYREX EM	SHAFT TYPE	T	SPECIAL DE	NONE	SPECIAL ODE	NONE	SHAFT MATERIAL	1144 STRESSPROOF (C-223)	FRAME MATERIAL	ROLLED STEEL		
THERMOSTATS T/STATS (N/C)	NOT	THERMO-PROTECTORS PROTECTORS	NOT	WDG RTDs	NONE	BRG RTDs	NONE	CONTROL	FALSE	SPACE IN HEATERS	NONE VOLTS						

If Inverter equals NONE, contact factory for further information

INVERTER TORQUE:	CONSTANT 10:1
INV. HP SPEED RANGE:	1.5 X BASE SPEED
ENCODER:	NONE
	NONE
	NONE
	NONE PPR
BRAKE:	NONE
	NONE
	PIN NONE
	NONE
	NONE FT-LB
	NONE V
	NONE HZ

\* N O T E S \*

