

# PRODUCT INFORMATION PACKET

Model No: 145TTDR6028

Catalog No: U759

1 1/2, 1800, DP, 145T, 3/60/230/460

Open Drip Proof (ODP)



Regal and Marathon are trademarks of Regal Beloit Corporation or one of its affiliated companies.  
©2018 Regal Beloit Corporation, All Rights Reserved. MC017097E





### Nameplate Specifications

Output HP	1.50 Hp	Output KW	1.1 kW
Frequency	60 Hz	Voltage	230/460 V
Current	4.8/2.4 A	Speed	1750 rpm
Service Factor	1.15	Phase	3
Efficiency	86.5 %	Duty	Continuous
Insulation Class	F	Design Code	B
KVA Code	L	Frame	145T
Enclosure	Drip Proof	Overload Protector	No
Ambient Temperature	40 °C	Drive End Bearing Size	6205
Opp Drive End Bearing Size	6203	UL	Recognized
CSA	Y	CE	Y
IP Code	22		

### Technical Specifications

Electrical Type	Squirrel Cage Inverter Rated	Starting Method	Line Or Inverter
Poles	4	Rotation	Reversible
Mounting	Rigid base	Motor Orientation	Horizontal
Drive End Bearing	Ball	Opp Drive End Bearing	Ball
Frame Material	Rolled Steel	Shaft Type	T
Overall Length	12.62 in	Frame Length	7.50 in
Shaft Diameter	0.875 in	Shaft Extension	2.37 in
Assembly/Box Mounting	F1 Only		
Outline Drawing	034908-750	Connection Diagram	005010-20ME

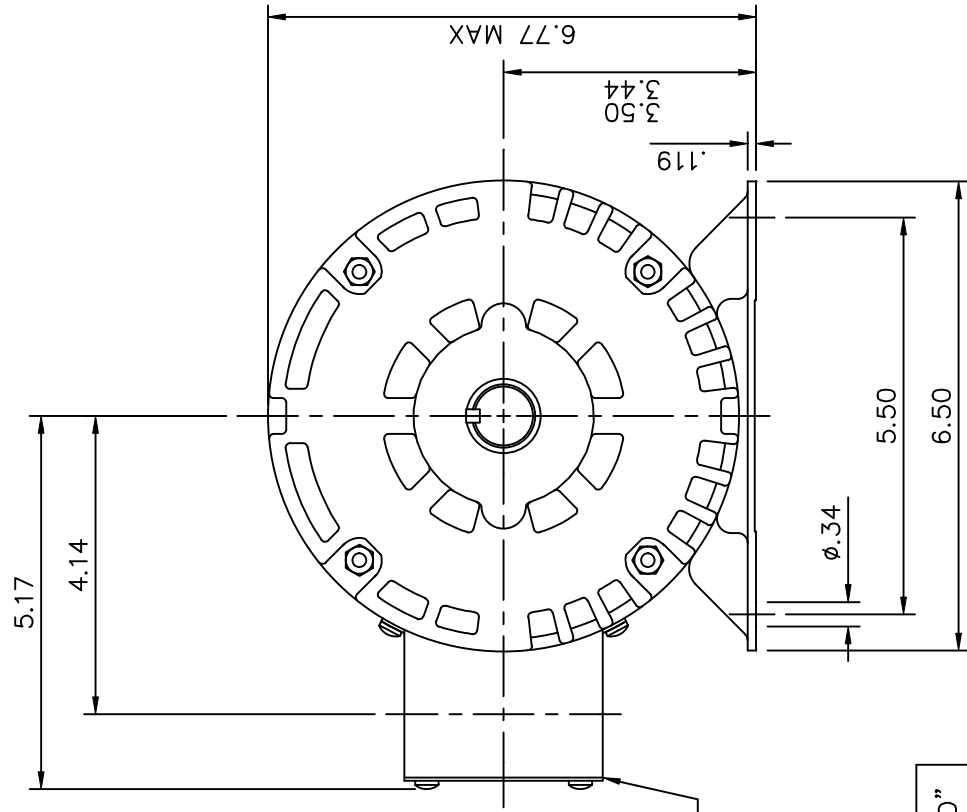

.19 SQ X 1.38 KEY

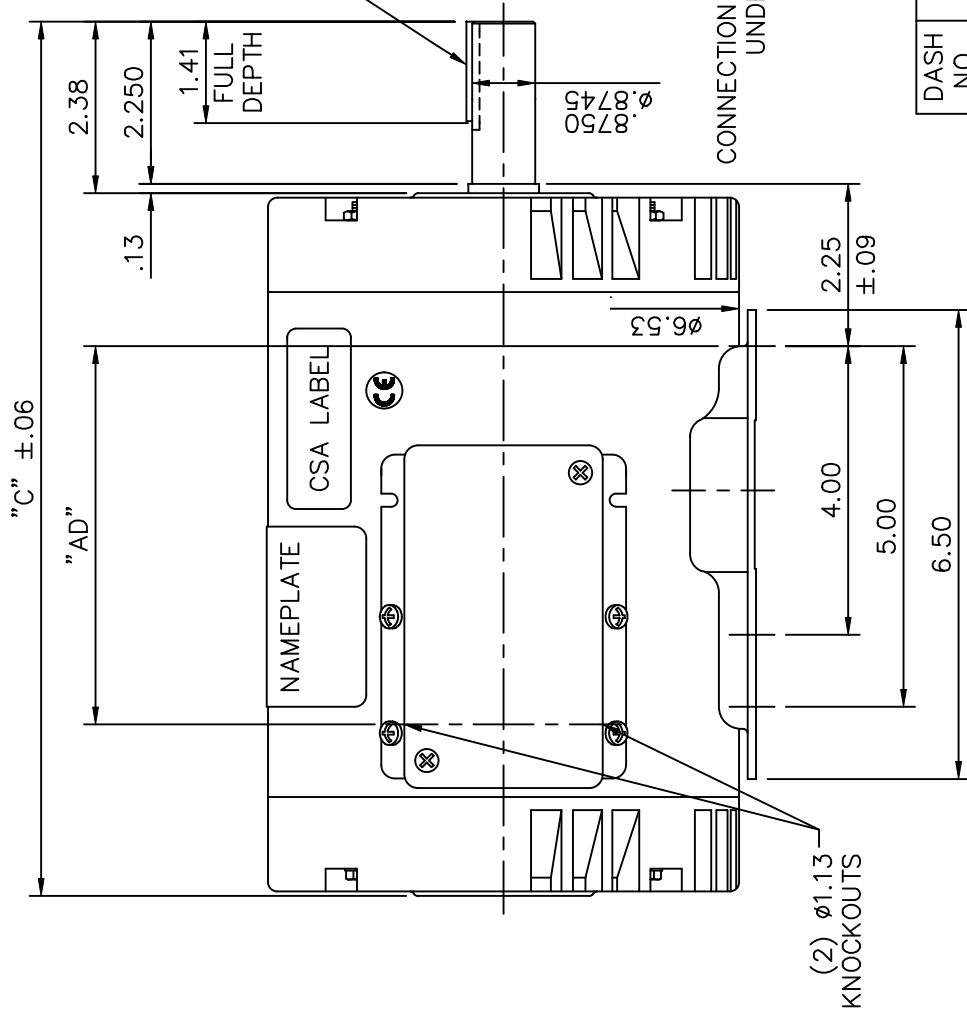

DECAL CONNECTION & TSTAT UNDER COVER

DASH NO.	"C"	"AD"
650	11.62	4.75
700	12.12	5.25
750	12.62	5.75
800	13.12	6.25
850	13.62	6.75

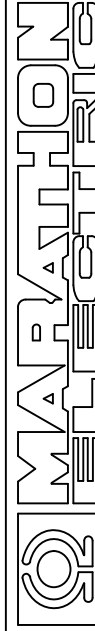

TITLE OUTLINE - 143T/145T FRAME  
DRIP PROOF - RIGID

DRAWN	RDW 12/13/01
CHK	
APPD	KMM 12/13/01
SCALE	3=8
REF	121003
FMF	
PREV	

TOLERANCES UNLESS SPECIFIED	
DEC.	INCHES
.X	±.1
.XX	±.03
.XXX	±.005
.XXXX	±.0005
ANG	±1/2°

NO.	01	ADDED CE LABEL	ARV 8/8/05	BY & DATE	CHK	ANG	12/13/01	RFP	034908	CAD FILE	034908	SIZE	A	DRAWING NO.	034908	REV.	01
THIS DRAWING IN DESIGN AND DETAIL IS OUR PROPERTY AND MUST NOT BE USED EXCEPT IN CONNECTION WITH OUR WORK ALL RIGHTS OF DESIGN AND INVENTION ARE RESERVED THIS IS AN ELECTRONICALLY GENERATED DOCUMENT - DO NOT SCALE THIS PRINT 7/3/2007 9:41:50 AM -																	

VIEW FROM OUTSIDE OF MOTOR AT SWITCH END.

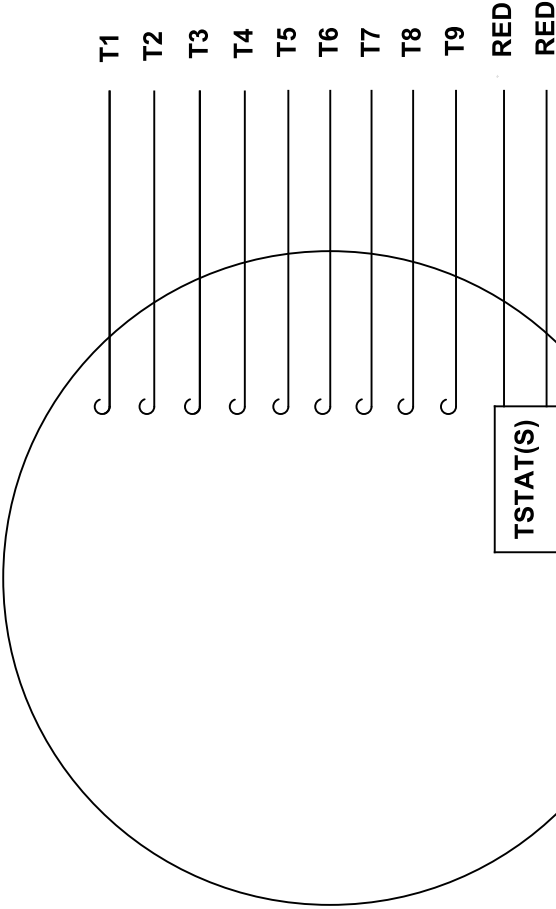

LINE LEADS

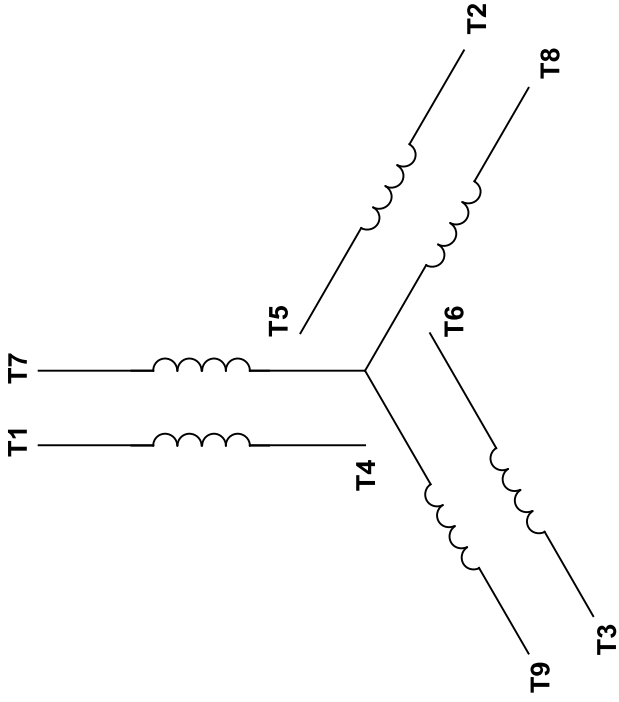

VOLTAGE	L1	L2	L3	JOIN & INSULATE
HIGH	T1	T2	T3	(T4, T7) (T5, T8) (T6, T9)
LOW	T1, T7	T2, T8	T3, T9	T4, T5, T6

RBC PROPRIETARY AND CONFIDENTIAL INFORMATION  
 This document is the property of REGAL BELOIT CORPORATION ("RBC") including its subsidiaries and divisions and contains proprietary information of RBC. This document is loaned on the express condition that neither it nor the information contained therein shall be disclosed to others without the express written consent of RBC, and that the information shall be used by the recipient only as approved expressly by RBC. This document shall be returned to RBC upon its request. This document may be subject to certain restrictions under U.S. export control laws and regulations.

TOLERANCES UNLESS SPECIFIED		DRAWN RDW 04/13/04	
DEC	INCHES	CHK	
.X	±.1	APPR	
.XX	±.01	SCALE	1:1
.XXX	±.005	REF	
.XXXX	±.0005	FMF	129027
CHK	ANG ±1/2°	PAGE	OF
BY & DATE	REV	FINISH	
VJB 02/08/11		PREV	
REVISION	THIRD ANGLE PROJECTION	NETWORK FILE NAME	00501020ME
REDRAWN IN SOLIDWORKS		SIZE	A
		DRAWING NO	005010-20ME
		REV	--

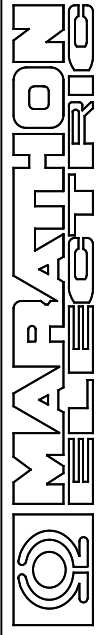

TITLE EXTERNAL WIRING DIAGRAM  
 3 PHASE

MAT'L DECAL - 004014 (TSTAT) - 080582

CERTIFICATION DATA SHEET

Model#: 145TTDR6028 AA  
 CONN. DIAGRAM: 005010-20MIE  
 OUTLINE: 034908-750

WINDING#: T634341 DR 3  
 ASSEMBLY: F1 ONLY

TYPICAL MOTOR PERFORMANCE DATA

HP	KW	SYNC. RPM	F.L. RPM	FRAME	ENCLOSURE	KVA CODE	DESIGN	
1.1/2&1	1.12&0.75	1800	1750&1450	145T	DP	L	B	
PH	HZ	VOLTS	START TYPE	DUTY	INSL	S.F	AMB°C	ELEVATION
3	60/50	230/460/190/380	4.8/2.4&3.6/1.8 INVERTER	CONTINUOUS	F4	1.15/1.15	40	3300
FULL LOAD EFF: 86.5&86.5	3/4 LOAD EFF: 87	1/2 LOAD EFF: 84.2	GTD. EFF	ELEC. TYPE	NO LOAD AMPS			
FULL LOAD PF: 67.7&67.5	3/4 LOAD PF: 67.2	1/2 LOAD PF: 55.1	0	SQ CAGE INV/RATED	2.5/1.2			
F.L. TORQUE 4.5 LB-FT	LOCKED ROTOR AMPS 36.1 / 18	L.R. TORQUE 14.75 LB-FT 328	B.D. TORQUE 19.8 LB-FT 440	F.L. RISE°C 0				
SOUND PRESSURE @ 3 FT.	SOUND POWER	ROTOR WK*2	MAX. WK*2	SAFE STALL TIME	STARTS /HOUR	APPROX. MOTOR WGT		
0 dBA	10 dBA	0.144 LB-FT*2	0.1 LB-FT*2	10 SEC.	0	0 LBS.		

\*\*\* SUPPLEMENTAL INFORMATION \*\*\*

DE BRACKET TYPE	ODE BRACKET TYPE	MOUNT TYPE	ORIENTATION	SEVERE DUTY	HAZARDOUS LOCATION	DRIP COVER	SCREENS	PAINT
STANDARD	STANDARD	RIGID	HORIZONTAL	FALSE	NONE	FALSE	NONE	GREEN (ENAMEL)
BEARINGS DE	OPE	GREASE	SHAFT TYPE	SPECIAL DE	SPECIAL ODE	SHAFT MATERIAL	FRAME MATERIAL	
BALL 6205	BALL 6203	POLYREX EM	T	NONE	NONE	1144 STRESSPROOF (C-223)	ROLLED STEEL	
THERMOSTATS TSTATS (N/C)	PROTECTORS	WDG RTDs	BRG RTDs	CONTROL	SPACE IN HEATERS			
	NOT	NONE	NONE	FALSE	NONE VOLTS			

If Inverter equals NONE, contact factory for further information

INVERTER TORQUE: CONSTANT 10:1
INV. HP SPEED RANGE: 1.5 X BASE SPEED
ENCODER: NONE
NONE NONE
NONE NONE PPR
BRAKE: NONE NONE
NONE PIN NONE
NONE NONE
NONE FT-LB NONE V NONE HZ

\*  
N  
O  
T  
E  
S



Data Sheet

Date: 19-06-2017  
 Customer: \_\_\_\_\_  
 Attention: \_\_\_\_\_  
 Submitted by: FAREEDA DUDEKULA

145TTDR6028

Submittal  
 Data @ 460 V



Load	Motor Load Data							
	0%	25%	50%	75%	100%	115%	125%	LR
Current (Amps)	1.23	1.33	1.53	1.81	2.15	2.42	2.52	18.1
Torque (ft-lb)	0.00	1.13	2.25	3.4	4.5	5.6	14.8	0
RPM	1800	1786	1773	1746	1740	1732	1732	0
Efficiency (%)		76.1	84.2	87.0	86.5	85.9	85.9	80.1
P.F. (%)	9.9	35.5	55.1	67.2	70.0	74.0	80.1	0.0

Motor Speed Data				Information Block			
LR	Pull-Up	BD	Rated	Idle	HP	Frame	Enclosure
0	900	1600	1746	1800	1.5	140	DP
18.1	16.0	12.1	2.15	1.23	1800	140	DP
14.8	13.5	19.8	4.5	0.00	1800	140	DP

