

PRODUCT INFORMATION PACKET

marathon[®]
Motors

Model No: 143TTDR6027
Catalog No: U758
1,1800,DP,143T,3/60/230/460
Open Drip Proof (ODP)



Regal and Marathon are trademarks of Regal Beloit Corporation or one of its affiliated companies.
©2018 Regal Beloit Corporation, All Rights Reserved. MC017097E

REGAL



Nameplate Specifications

Output HP	1 Hp	Output KW	0.75 kW
Frequency	60 Hz	Voltage	230/460 V
Current	3.2/1.6 A	Speed	1760 rpm
Service Factor	1.15	Phase	3
Efficiency	85.5 %	Duty	Continuous
Insulation Class	F	Design Code	B
KVA Code	N	Frame	143T
Enclosure	Drip Proof	Overload Protector	No
Ambient Temperature	40 °C	Drive End Bearing Size	6205
Opp Drive End Bearing Size	6203	UL	Recognized
CSA	Y	CE	Y
IP Code	22		

Technical Specifications

Electrical Type	Squirrel Cage Induction Run	Starting Method	Across The Line
Poles	4	Rotation	Reversible
Mounting	Rigid base	Motor Orientation	Horizontal
Drive End Bearing	Ball	Opp Drive End Bearing	Ball
Frame Material	Rolled Steel	Shaft Type	T
Overall Length	12.12 in	Frame Length	7.00 in
Shaft Diameter	0.875 in	Shaft Extension	2.38 in
Assembly/Box Mounting	F1 Only		
Outline Drawing	034908-700	Connection Diagram	005010.20ME

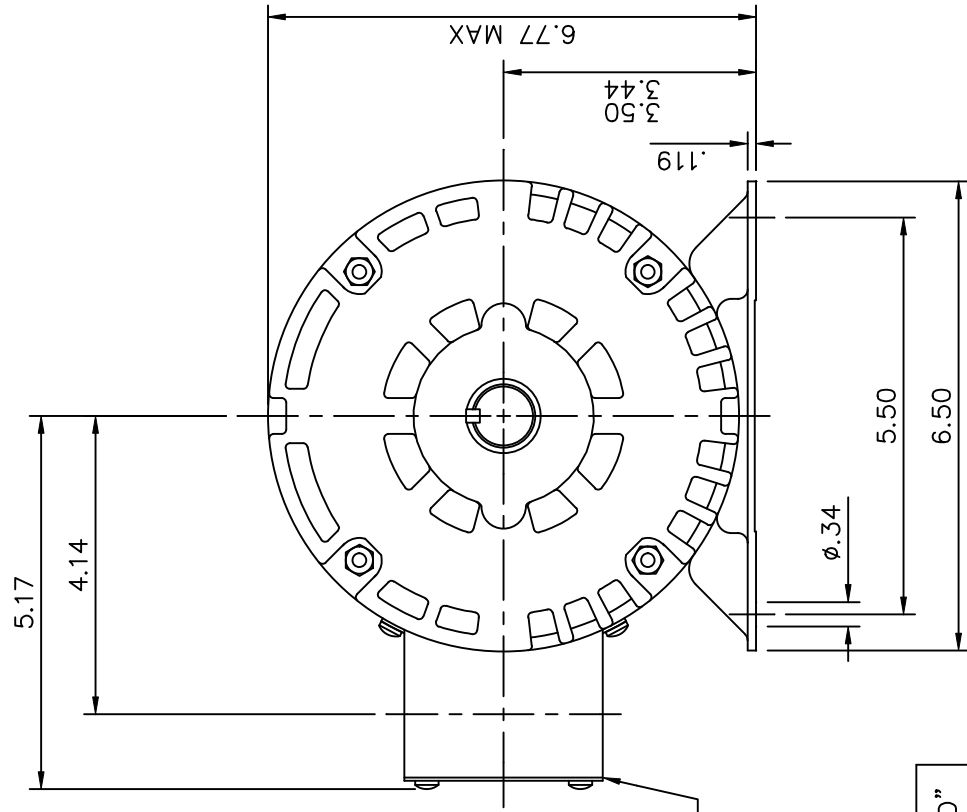

.19 SQ X 1.38 KEY

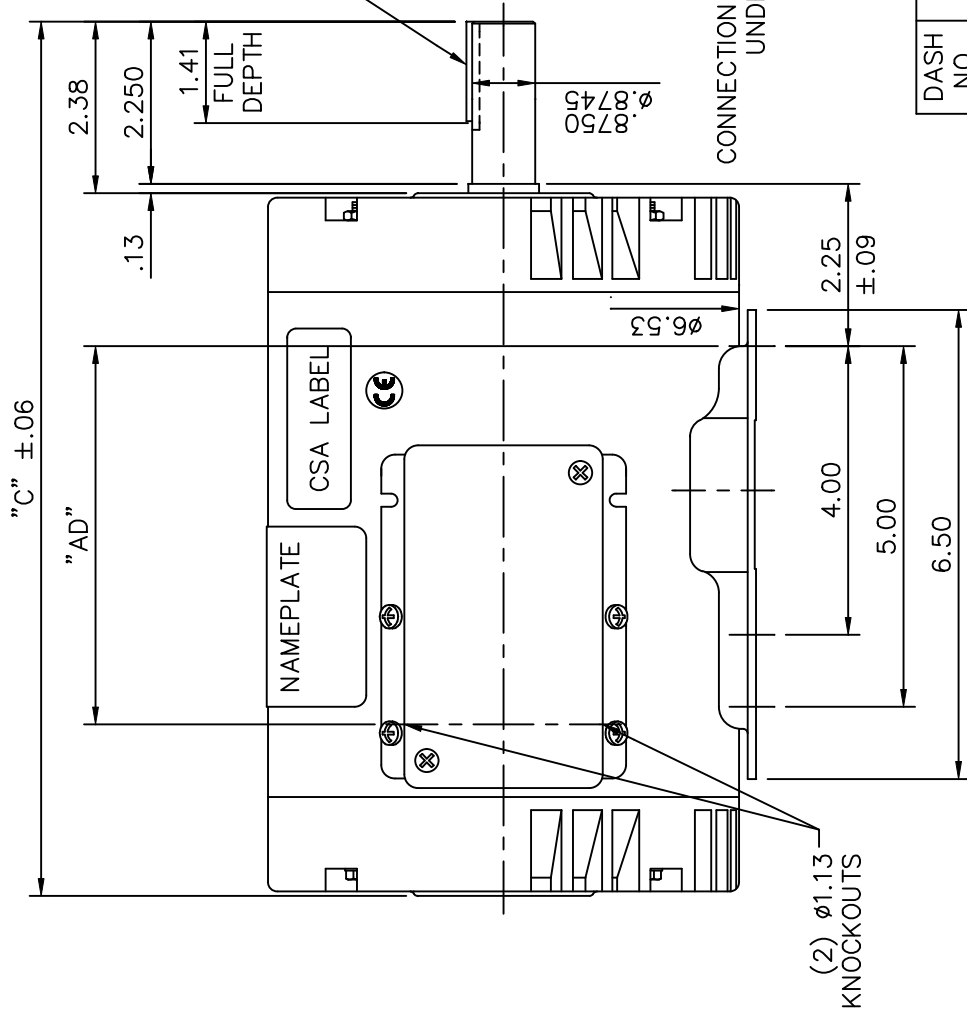

DASH NO.	"C"	"AD"
650	11.62	4.75
700	12.12	5.25
750	12.62	5.75
800	13.12	6.25
850	13.62	6.75

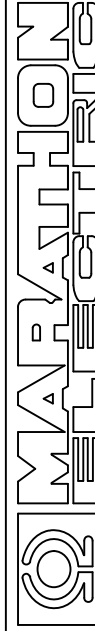

TITLE OUTLINE - 143T/145T FRAME
DRIP PROOF - RIGID

DRAWN	RDW 12/13/01
CHK	
APPD	KMM 12/13/01
SCALE	3=8
REF	121003
FMF	
PREV	

TOLERANCES UNLESS SPECIFIED	
DEC.	INCHES
.X	±.1
.XX	±.03
.XXX	±.005
.XXXX	±.0005
ANG	±1/2°

NO.	01	ADDED CE LABEL	ARV 8/8/05	BY & DATE	CHK	ANG	12/13/01	CAD FILE	034908	SIZE	A	DRAWING NO.	034908	REV.	01
THIS DRAWING IN DESIGN AND DETAIL IS OUR PROPERTY AND MUST NOT BE USED EXCEPT IN CONNECTION WITH OUR WORK ALL RIGHTS OF DESIGN AND INVENTION ARE RESERVED THIS IS AN ELECTRONICALLY GENERATED DOCUMENT - DO NOT SCALE THIS PRINT															

VIEW FROM OUTSIDE OF MOTOR AT SWITCH END.

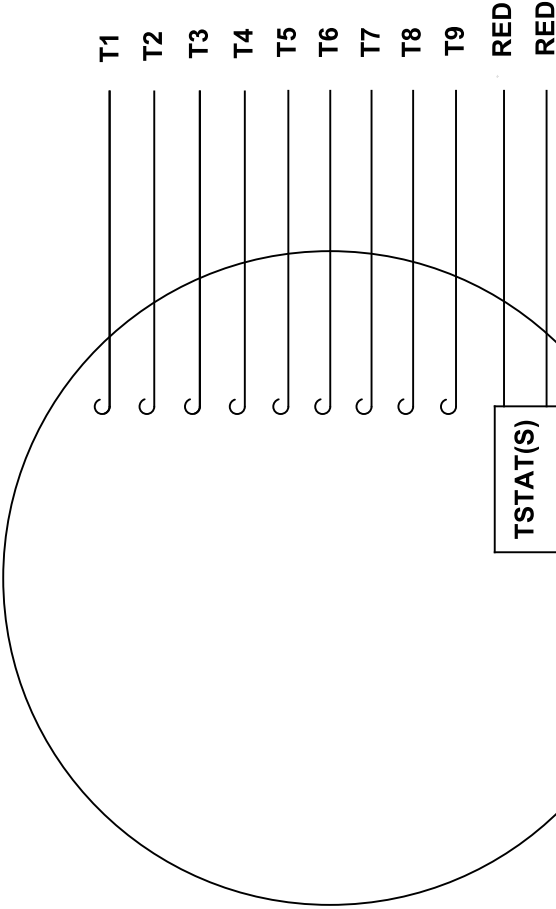

LINE LEADS

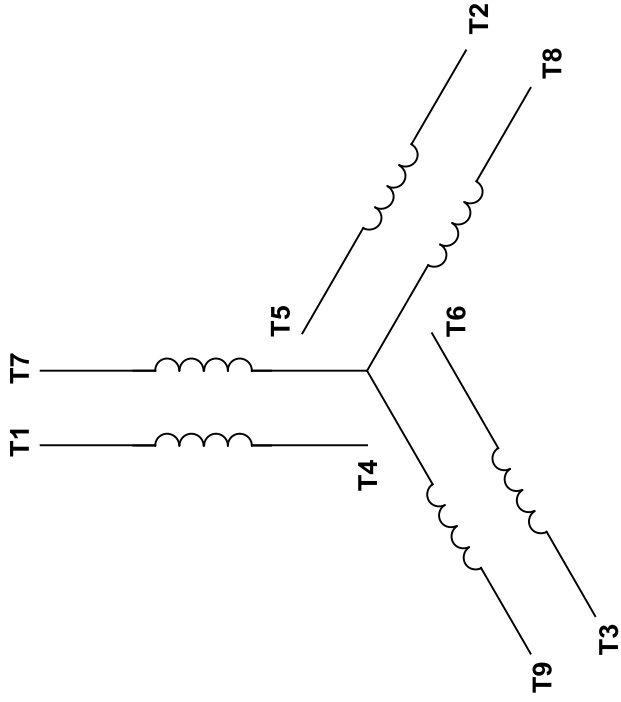

VOLTAGE	L1	L2	L3	JOIN & INSULATE
HIGH	T1	T2	T3	(T4, T7) (T5, T8) (T6, T9)
LOW	T1, T7	T2, T8	T3, T9	T4, T5, T6

RBC PROPRIETARY AND CONFIDENTIAL INFORMATION
 This document is the property of REGAL BELOIT CORPORATION ("RBC") including its subsidiaries and divisions and contains proprietary information of RBC. This document is loaned on the express condition that neither it nor the information contained therein shall be disclosed to others without the express written consent of RBC, and that the information shall be used by the recipient only as approved expressly by RBC. This document shall be returned to RBC upon its request. This document may be subject to certain restrictions under U.S. export control laws and regulations.

TOLERANCES UNLESS SPECIFIED		DRAWN RDW 04/13/04	
DEC	INCHES	CHK	
.X	±.1	APPR	
.XX	±.01	SCALE	1:1
.XXX	±.005	REF	
.XXXX	±.0005	FMF	129027
CHK	ANG ±1/2°	PAGE	OF
BY & DATE	REV	SIZE	DRAWING NO
VJB 02/08/11		A	005010-20ME
REVISION	THIRD ANGLE PROJECTION	NETWORK FILE NAME 00501020ME	
REDRAWN IN SOLIDWORKS		FINISH	
		MAT'L DECAL - 004014 (TSTAT) - 080582	
		TITLE EXTERNAL WIRING DIAGRAM 3 PHASE	
		PREV	
		REV	
		REV	

CERTIFICATION DATA SHEET

Model#: 143TDR6027 AA
 CONN. DIAGRAM: 005010.20ME
 OUTLINE: 034908-700

WINDING#: T634342 DR 3
 ASSEMBLY: F1 ONLY

TYPICAL MOTOR PERFORMANCE DATA

HP	KW	SYNC. RPM	F.L. RPM	FRAME	ENCLOSURE	KVA CODE	DESIGN	
1.83/4	.75&.56	1800	1760&1450	143T	DP	N	B	
PH	HZ	VOLTS	START TYPE	DUTY	INSL	S.F	AMB°C	ELEVATION
3	60/50	230/460/190/380	3.2/1.6&2.8/1.4	CONTINUOUS	F4	1.15/1.15	40	3300
FULL LOAD EFF: 85.5&84	3/4 LOAD EFF: 85.2	1/2 LOAD EFF: 81.7	GTD. EFF	ELEC. TYPE	NO LOAD AMPS			
FULL LOAD PF: 68.5&72	3/4 LOAD PF: 62.8	1/2 LOAD PF: 48	84	SO CAGE IND RUN	2 / 1			
F.L. TORQUE	LOCKED ROTOR AMPS	L.R. TORQUE	B.D. TORQUE	F.L. RISE°C				
3 LB-FT	28 / 14	12 LB-FT 0	15.8 LB-FT 0	21				
SOUND PRESSURE @ 3 FT.	SOUND POWER	ROTOR WK*2	MAX. WK*2	SAFE STALL TIME	STARTS / HOUR	APPROX. MOTOR WGT		
0 dBA	10 dBA	0.117 LB-FT*2	0.1 LB-FT*2	10 SEC.	2	0 LBS.		

*** SUPPLEMENTAL INFORMATION ***

DE BRACKET TYPE	ODE BRACKET TYPE	MOUNT TYPE	ORIENTATION	SEVERE DUTY	HAZARDOUS LOCATION	DRIP COVER	SCREENS	PAINT
STANDARD	STANDARD	RIGID	HORIZONTAL	FALSE	NONE	FALSE	NONE	GREEN (ENAMEL)
BEARINGS	GREASE	SHAFT TYPE	SPECIAL DE	SPECIAL ODE	SHAFT MATERIAL	FRAME MATERIAL		
DE	OPE							
BALL 6205	POLYREX EM 6203	T	NONE	NONE	1144 STRESSPROOF (C-223)	ROLLED STEEL		
THERMOSTATS	TSTATS (N/C)	PROTECTORS	WDG RTDs	BRG RTDs	CONTROL	SPACE IN HEATERS		
	NOT		NONE	NONE	FALSE	NONE VOLTS		

If Inverter equals NONE, contact factory for further information

INVERTER TORQUE: NONE
INV. HP SPEED RANGE: NONE
ENCODER: NONE
NONE NONE
NONE NONE PPR
BRAKE: NONE NONE
NONE PIN NONE
NONE NONE
NONE FT-LB NONE V NONE HZ

*
N
O
T
E
S

Data Sheet

Date: 29-06-2017
 Customer: _____
 Attention: _____
 Submitted by: FAREEDA DUDEKULA

143TTDR6027

Submittal
 Data @ 460 V



Load	Motor Load Data						
	0%	25%	50%	75%	100%	115%	125%
Current (Amps)	0.99	1.10	1.19	1.31	1.60	1.80	1.90
Torque (ft-lb)	0.00	0.73	1.47	2.22	2.98	3.4	3.8
RPM	1800	1791	1780	1770	1760	1754	1749
Efficiency (%)		72.8	81.7	85.2	86.0	84.7	
P.F. (%)	8.2	29.1	48.0	62.8	68.5	69.4	72.7

Motor Speed Data			
LR	Pull-Up	BD	Rated
0	900	1575	1760
Speed (RPM)	14.5	13.0	9.9
Current (Amps)	12.0	11.0	15.0
Torque (ft-lb)			2.98
HP			0.99
Sync. RPM			1800
Frame			140

Information Block				
Construction	DP			
Enclosure	TDR			
Construction	230/460#190-384V			
Voltage	60 Hz			
Frequency	A			
Design	N			
LR Code letter	1-15			
Service Factor	21 ° C			
Temp Rise @ FL	40 ° C			
Duty	1,000 feet			
Ambient	0.12 LB-FF ²			
Elevation	T634342 DR			
Factor/Shaft wk ²	0			
Ref Wdg	Sound Pressure @ 1M			
	0 dBA			
	VFD Rating			
	NONE			
	Outline Dwg			
	034908-700			
	Conn. Diag			
	005010-20ME			
	Additional Specifications:			
	0			
	365THFS8036			
	EQUIV CKT (OHMS / PHASE)			
R1	R2	X1	X2	Xm
0.0000	0.0000	0.0000	0.0000	0.0000

