

Honeywell

Operating Manual



FocusPRO™ TH5220D

Non-programmable Digital Thermostat

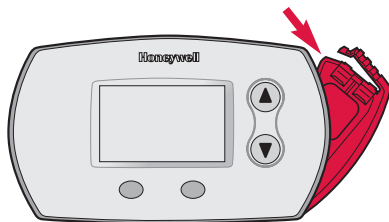

Battery Holder

Press down and pull to remove batteries. Batteries should be replaced once a year (see page 10).

Need Help?

For assistance with this product please visit www.honeywell.com/yourhome
or call Honeywell Customer Care toll-free at **1-800-468-1502**

Read and save these instructions

® U.S. Registered Trademark. Patents pending.

Copyright © 2005 Honeywell International Inc. All rights reserved.

Table of contents

About your new thermostat

Thermostat features	2
Setup at a glance	3
Quick reference to controls.....	4
Quick reference to display.....	5

Programming & Operation

Fan setting (auto/on)	6
System setting (heat/cool/auto).....	7
Auto-changeover (heat/cool)	8
Compressor protection	9

Appendices

Battery replacement.....	10
In case of difficulty	11
Customer assistance.....	13
Accessories/replacement parts ...	13
Limited warranty	14



CAUTION: EQUIPMENT DAMAGE HAZARD. To prevent possible compressor damage, do not operate cooling system when outdoor temperature is below 50°F (10°C).

About your new thermostat

Congratulations on the purchase of your new Honeywell thermostat. It has been designed to give you many years of reliable service and easy-to-use, push-button climate control.

Features

- One-touch temperature control.
- Large, clear, backlit display is easy to read — even in the dark.
- Displays both room temperature and temperature setting.
- Removable battery holder for fast, easy replacement.
- Built-in compressor protection.

This thermostat is ready to go!

Your new thermostat is pre-programmed by the installer and ready to use. Just check the settings below and change if needed:

- 1 **Fan (Auto/On):** Preset to AutoTo change, see page 6
Auto is the most commonly used setting, but you may prefer On for improved air circulation.
- 2 **System (Heat/Cool/Auto/Em. Heat):** Preset to HeatTo change, see page 7
You can select heating or cooling, or set the system to control both systems automatically, if needed.

Quick reference to controls

Digital display (see page 5)

Battery holder (see page 10)

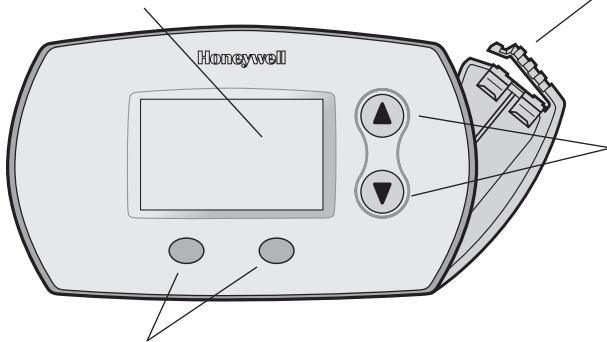

Temperature buttons
Press to set preferred temperature.

Function buttons

Press to select the function displayed just above each button.
(Functions change depending on the task.)

Quick reference to display screen

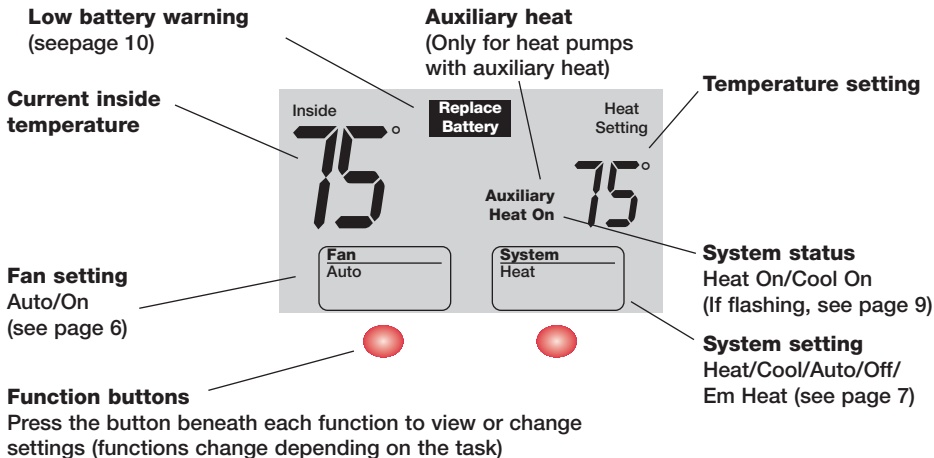

Select the fan setting



Press the **FAN** button to select Auto or On.

In “Auto” mode (the most commonly used setting), the fan runs only when the heating or cooling system is on. If set to “On,” the fan runs continuously. Use this setting for improved air circulation, or for more efficient air cleaning.

Select the system setting



Press the **SYSTEM** button to select:

- **Heat:** Thermostat controls only the heating system.
- **Cool:** Thermostat controls only the cooling system.
- **Off:** Heating and cooling systems are off.
- **Auto:** Thermostat automatically selects heating or cooling depending on the indoor temperature.
- **Em Heat** (only for heat pumps with auxiliary heat): Thermostat controls Emergency and Auxiliary Heat. Compressor is locked out.



Note: The Auto and Em Heat system settings may not appear, depending on how your thermostat was installed.

Auto Changeover (heat/cool)

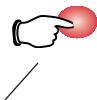

Press until screen displays "Auto"



Note: The Auto system setting may not appear, depending on how your thermostat was installed.

Auto Changeover is a feature used in climates where both air conditioning and heating are used on the same day. When the system is set to Auto, the thermostat automatically selects heating or cooling depending on the indoor temperature.

Heat and cool settings must be at least 3 degrees apart. The thermostat will automatically adjust settings to maintain this 3-degree separation (called "deadband").

The 3-degree separation between heating and cooling set temperatures is fixed, and cannot be changed.

Built-in compressor protection

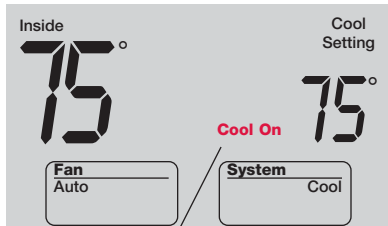

Message flashes until safe restart time has elapsed

This feature helps prevent damage to the compressor in your air conditioning or heat pump system.

Damage can occur if the compressor is restarted too soon after shutdown. This feature forces the compressor to wait for a few minutes before restarting.

During the wait time, the display will flash the message Cool On (or Heat On if you have a heat pump). When the safe wait time has elapsed, the message stops flashing and the compressor turns on.

Battery replacement

Press and pull to remove

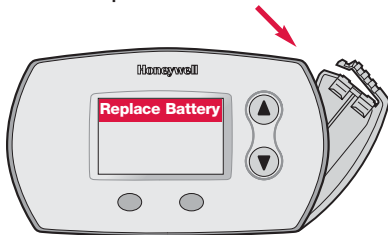

Insert fresh AA alkaline batteries, then reinstall battery holder

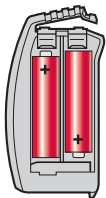

Batteries are optional (to provide backup power) if your thermostat was wired to run on AC power when installed.

Install fresh batteries immediately when the **REPLACE BATTERY** warning begins flashing. The warning flashes about two months before the batteries are depleted.

Even if the warning does not appear, you should replace batteries once a year, or before leaving home for more than a month.

Batteries provide backup power to the display during power interruptions. All other settings are permanently stored in memory, and do not require battery power.

In case of difficulty

If you have difficulty with your thermostat, please try the suggestions below. Most problems can be corrected quickly and easily.

- Display is blank**
- Check circuit breaker and reset if necessary.
 - Make sure power switch at heating & cooling system is on.
 - Make sure furnace door is closed securely.
 - If thermostat is battery powered, make sure fresh AA alkaline batteries are correctly installed (see page 10).
- Temperature settings do not change**
- Make sure heating and cooling temperatures are set to acceptable ranges:
- Heat: 40° to 90°F (4.5° to 32°C).
 - Cool: 50° to 99°F (10° to 37°C).

In case of difficulty

Heating or cooling system does not respond

- Press **SYSTEM** button to set system to Heat. Make sure the temperature is set higher than the Inside temperature.
- Press **SYSTEM** button to set system to Cool. Make sure the temperature is set lower than the Inside temperature.
- Check circuit breaker and reset if necessary.
- Make sure power switch at heating & cooling system is on.
- Make sure furnace door is closed securely.
- Wait 5 minutes for the system to respond.

“Cool On” or “Heat On” is flashing

- Compressor protection feature is engaged. Wait 5 minutes for the system to restart safely, without damage to the compressor (see page 9).

Customer assistance

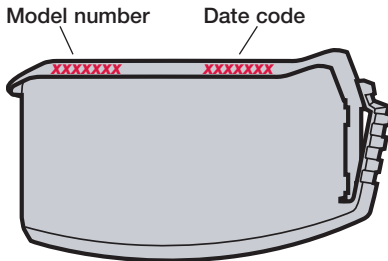

For assistance with this product, please visit www.honeywell.com/yourhome. Or call Honeywell Customer Care toll-free at **1-800-468-1502**.

To save time, please remove the battery holder and note your model number and date code before calling.

Accessories/replacement parts

To order, please call Honeywell Customer Care toll-free at **1-800-468-1502**.

- Battery holder**.....Part No. 50007072-001
- Cover plate assembly**Part No. 50002883-001
(Use to cover marks left by old thermostats.)

Limited 5-year warranty

Honeywell warrants this product, excluding battery, to be free from defects in the workmanship or materials, under normal use and service, for a period of five (5) years from the date of purchase by the consumer. If at any time during the warranty period the product is determined to be defective or malfunctions, Honeywell shall repair or replace it (at Honeywell's option).

If the product is defective,

(i) return it, with a bill of sale or other dated proof of purchase, to the place from which you purchased it; or

(ii) call Honeywell Customer Care at 1-800-468-1502. Customer Care will make the determination whether the product should be returned to the following address: Honeywell Return Goods, Dock 4 MN10-3860, 1885 Douglas Dr. N., Golden Valley, MN 55422, or whether a replacement product can be sent to you.

Limited 5-year warranty

This warranty does not cover removal or reinstallation costs. This warranty shall not apply if it is shown by Honeywell that the defect or malfunction was caused by damage which occurred while the product was in the possession of a consumer.

Honeywell's sole responsibility shall be to repair or replace the product within the terms stated above. **HONEYWELL SHALL NOT BE LIABLE FOR ANY LOSS OR DAMAGE OF ANY KIND, INCLUDING ANY INCIDENTAL OR CONSEQUENTIAL DAMAGES RESULTING, DIRECTLY OR INDIRECTLY, FROM ANY BREACH OF ANY WARRANTY, EXPRESS OR IMPLIED, OR ANY OTHER FAILURE OF THIS PRODUCT.** Some states do not allow the exclusion or limitation of incidental or consequential damages, so this limitation may not apply to you.

Limited 5-year warranty

THIS WARRANTY IS THE ONLY EXPRESS WARRANTY HONEYWELL MAKES ON THIS PRODUCT. THE DURATION OF ANY IMPLIED WARRANTIES, INCLUDING THE WARRANTIES OF MERCHANTABILITY AND FITNESS FOR A PARTICULAR PURPOSE, IS HEREBY LIMITED TO THE FIVE-YEAR DURATION OF THIS WARRANTY. Some states do not allow limitations on how long an implied warranty lasts, so the above limitation may not apply to you.

This warranty gives you specific legal rights, and you may have other rights which vary from state to state.

If you have any questions concerning this warranty, please write Honeywell Customer Relations, 1985 Douglas Dr, Golden Valley, MN 55422 or call 1-800-468-1502. In Canada, write Retail Products ON15-02H, Honeywell Limited/Honeywell Limitée, 35 Dynamic Drive, Scarborough, Ontario M1V4Z9.

Automation and Control Solutions

Honeywell International Inc.

1985 Douglas Drive North

Golden Valley, MN 55422

www.honeywell.com/yourhome



Printed in U.S.A. on recycled paper containing at least 10% post-consumer paper fibers.

Honeywell Limited-Honeywell Limitée

35 Dynamic Drive

Scarborough, Ontario M1V 4Z9

® U.S. Registered Trademark.

© 2005 Honeywell International Inc.

Patents pending. All rights reserved.

69-1784 02-2005



69-1784

Honeywell